

Ordering number FP13028_LISA2-M-PIN

Family	Lisa2	FWHM	28 degrees
Type	Assembly	Efficiency	87 %
LED	LUXEON T	cd/lm	2.700
Color	Black	Gerber File	Available
Diameter	9.9 mm		
Height	6.8 mm		
Style	Round		
Optic Material	PMMA		
Holder Material	PC		
Fastening	Pin, glue		
Status	On production		

Ordering number FP13030_LISA2-M-CLIP

Family	Lisa2	FWHM	28 degrees
Type	Assembly	Efficiency	87 %
LED	LUXEON T	cd/lm	2.700
Color	Black	Gerber File	Available
Diameter	9.9 mm		
Height	6.8 mm		
Style	Round		
Optic Material	PMMA		
Holder Material	PC		
Fastening	Clips, glue		
Status	On production		

Ordering number FP13025_LISA2-W-PIN

Family	Lisa2	FWHM	36 degrees
Type	Assembly	Efficiency	86 %
LED	LUXEON T	cd/lm	2.000
Color	Black	Gerber File	Available
Diameter	9.9 mm		
Height	6.8 mm		
Style	Round		
Optic Material	PMMA		
Holder Material	PC		
Fastening	Pin, glue		
Status	On production		

Ordering number FP13031_LISA2-W-CLIP

Family	Lisa2	FWHM	36 degrees
Type	Assembly	Efficiency	86 %
LED	LUXEON T	cd/lm	2.000
Color	Black	Gerber File	Available
Diameter	9.9 mm		
Height	6.8 mm		
Style	Round		
Optic Material	PMMA		
Holder Material	PC		
Fastening	Clips, glue		
Status	On production		



Ordering number	C12469		
Description	1		
Family	Lisa2	FWHM	82 degrees
Type	Reflector	Efficiency	82 %
LED	LUXEON T	cd/lm	0.400
Color	White	Gerber File	Available
Diameter	9.9 mm		
Height	6.5 mm		
Style	Round		
Optic Material	PC		
Holder Material	-		
Fastening	-		
Status	On production		

NOTE: The typical divergence will be changed by different color, chip size and chip position tolerance. The typical total divergence is the full angle measured where the luminous intensity is half of the peak value.



PRODUCT DATASHEET

Lisa2 series

last update 27/9/2013

PHILIPS
LUMILEDS

GENERAL INFORMATION

- Product series especially designed & optimized for LUXEON T series of LEDs.
- Special care taken to make light distribution as uniform as possible.
- Lens material optical grade PMMA with high UV and temperature resistance. Allows use of high current and temperature conditions.

Please find more information about used material from below:

http://ledil.fi/sites/default/files/Documents/Technical/Material/PMMA%20N%20UL94_Yellow%20Card.pdf

<http://ledil.fi/sites/default/files/Documents/Technical/Material/PMMA%20N%20PLEXIGLAS-Datasheet.pdf>

- Reflector is made of aluminium coated PC (120 degrees of Celcius / 248 degrees of Fahrenheit) with protective lacquer (110 degrees of Celcius / 230 degrees of Fahrenheit).
- Optic holder molded by high quality PC material (120 dergees of Celcius / 248 degrees of Fahrenheit).

Relative intensity of C12469_LISA2-R-PIN (Seoul Z5)

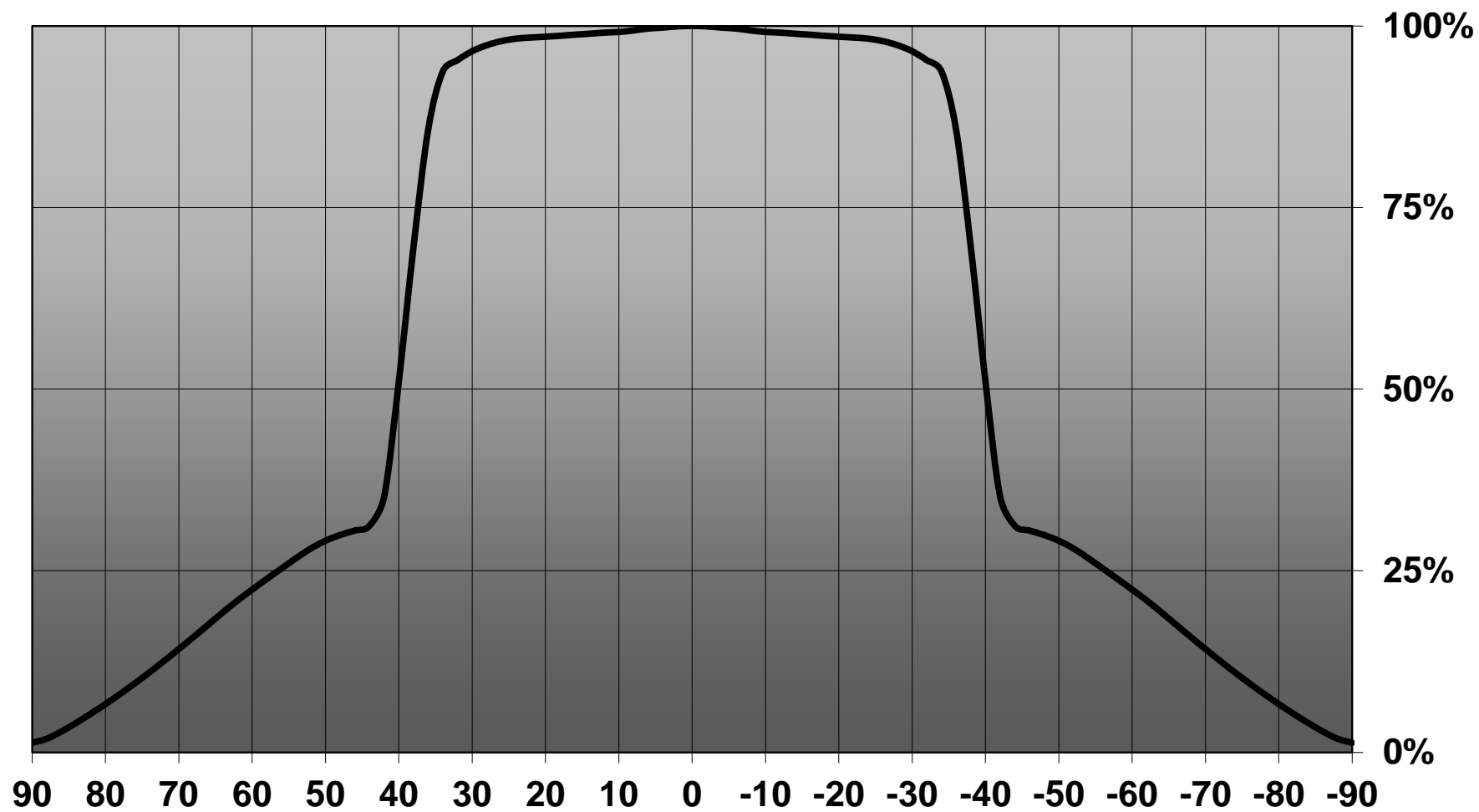

D

C

B

A

4

4

3

3

2

2

1

1

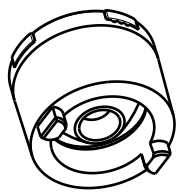
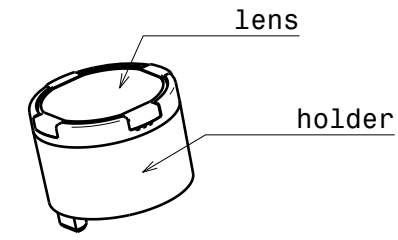

Isometric view
Scale: 2:1

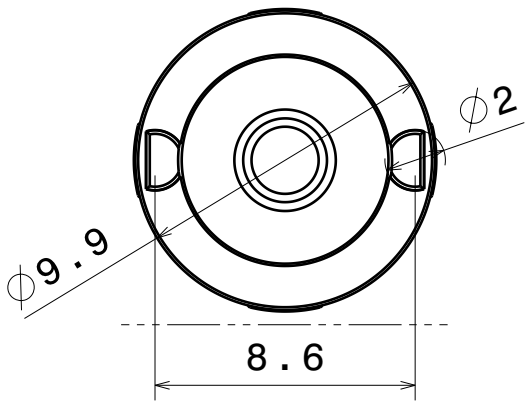

Bottom view

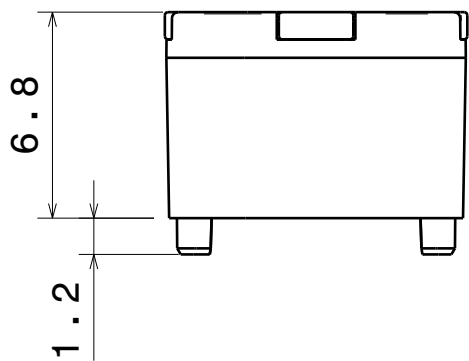

Front view

Materials:
Lens PMMA
Holder PC

This drawing is our property.
It can't be reproduced
or communicated without
our written agreement.



Ledil Oy
Salorankatu 10
FIN-24240 SALO
Finland

DRAWING TITLE
Datasheet Lisa2-Pin-XT Series Assy

DRAWN BY pl	DATE 20.06.2012
CHECKED BY	DATE
DESIGNED BY pl	DATE 20.06.2012

SIZE A4	DRAWING NUMBER	REV 1
SCALE 4:1	WEIGHT (g)	SHEET 1/1

D

A

Luminaire: LEDiL Oy FP13030&FP13028_LISA2-M_(CLIP&PIN) Eff.86.6%
Lamps: 1 x LUXEON_T (74lm@250mA)

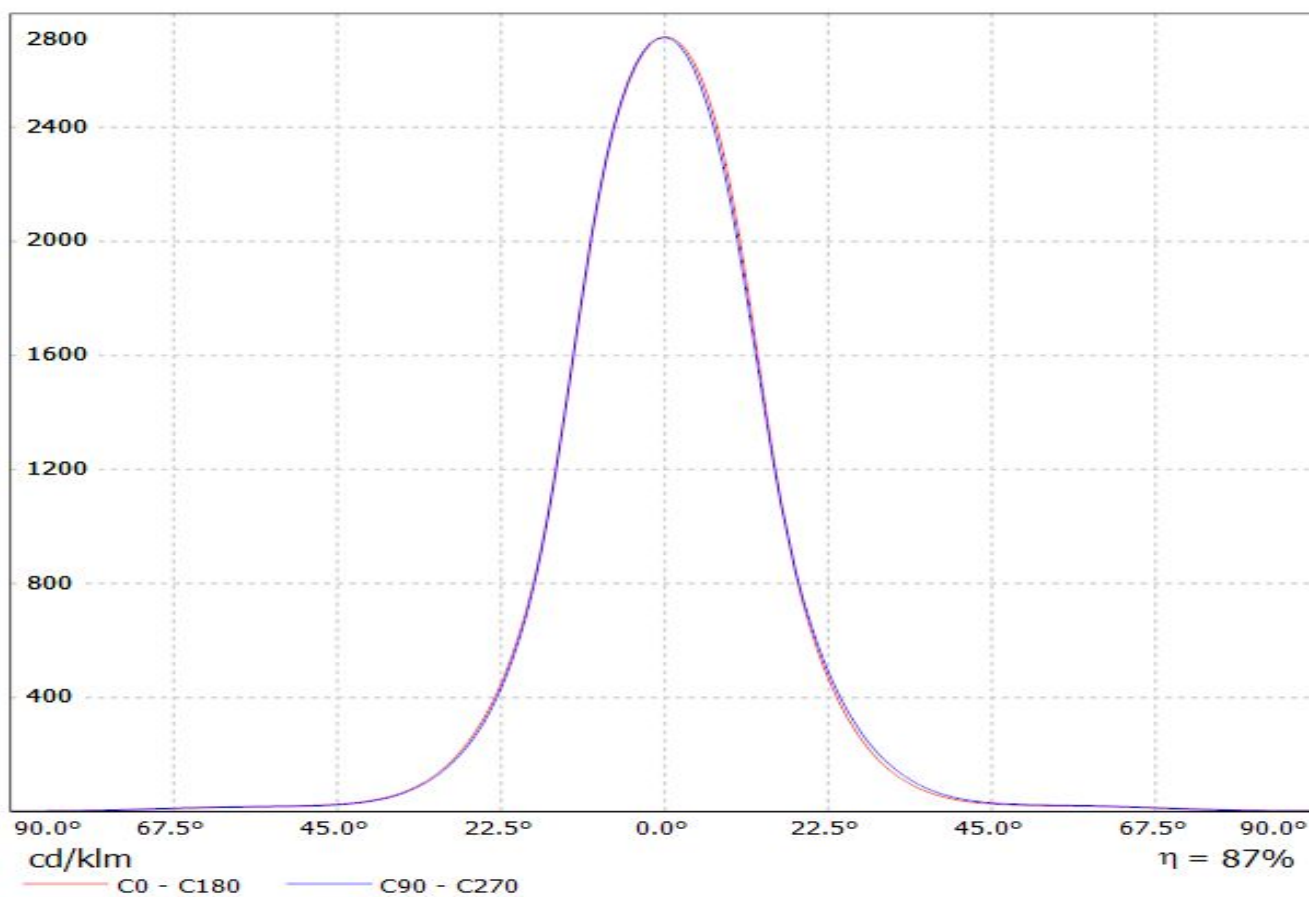

Luminaire: LEDiL Oy FP13030&FP13028_LISA2-M_(CLIP&PIN) Eff.86.6%
Lamps: 1 x LUXEON_T (74lm@250mA)

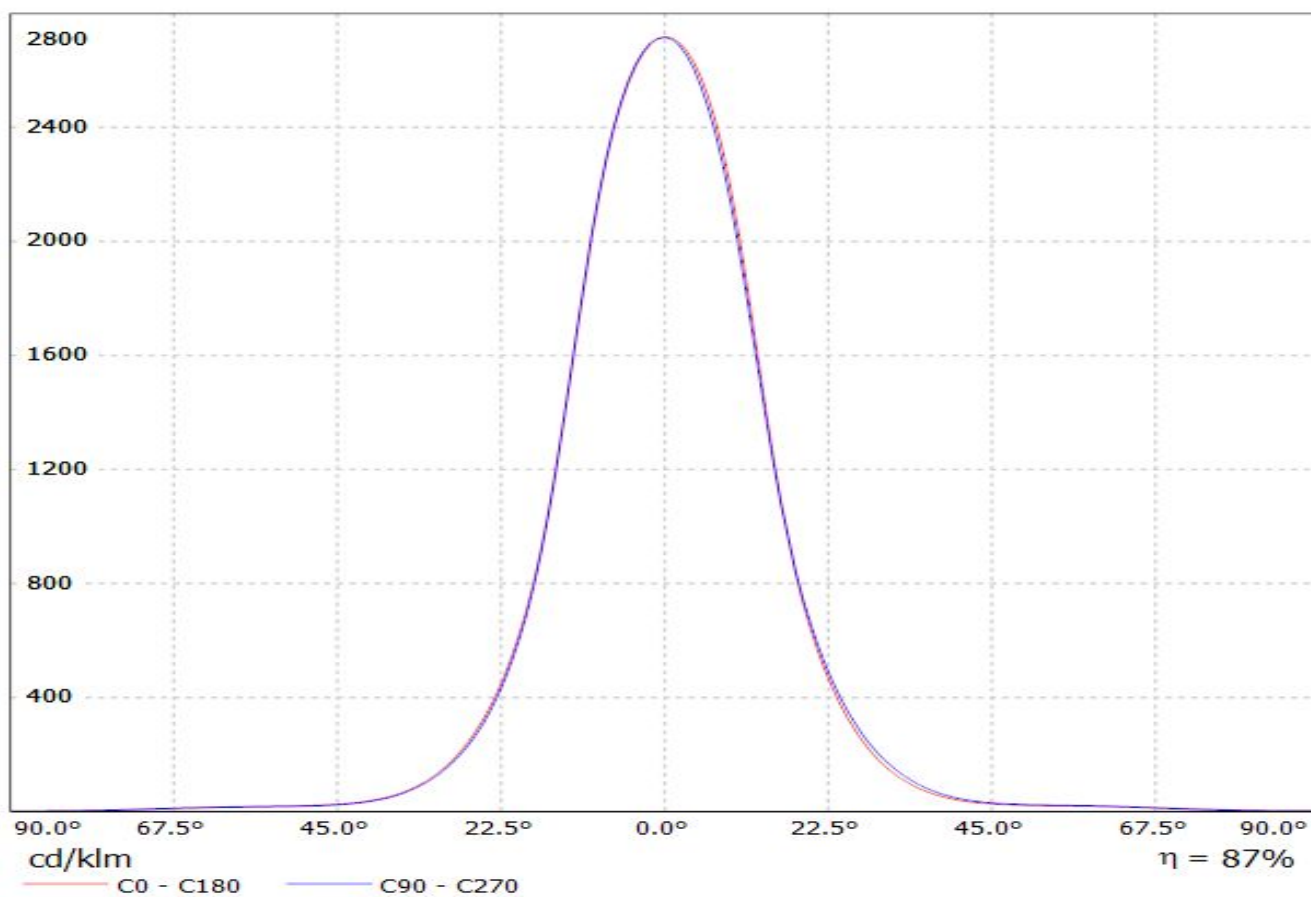

Luminaire: LEDiL Oy FP13031 & FP13025_LISA2-W_(CLIP/PIN) Eff.86.1%
Lamps: 1 x LUXEON_T (74lm@250mA)

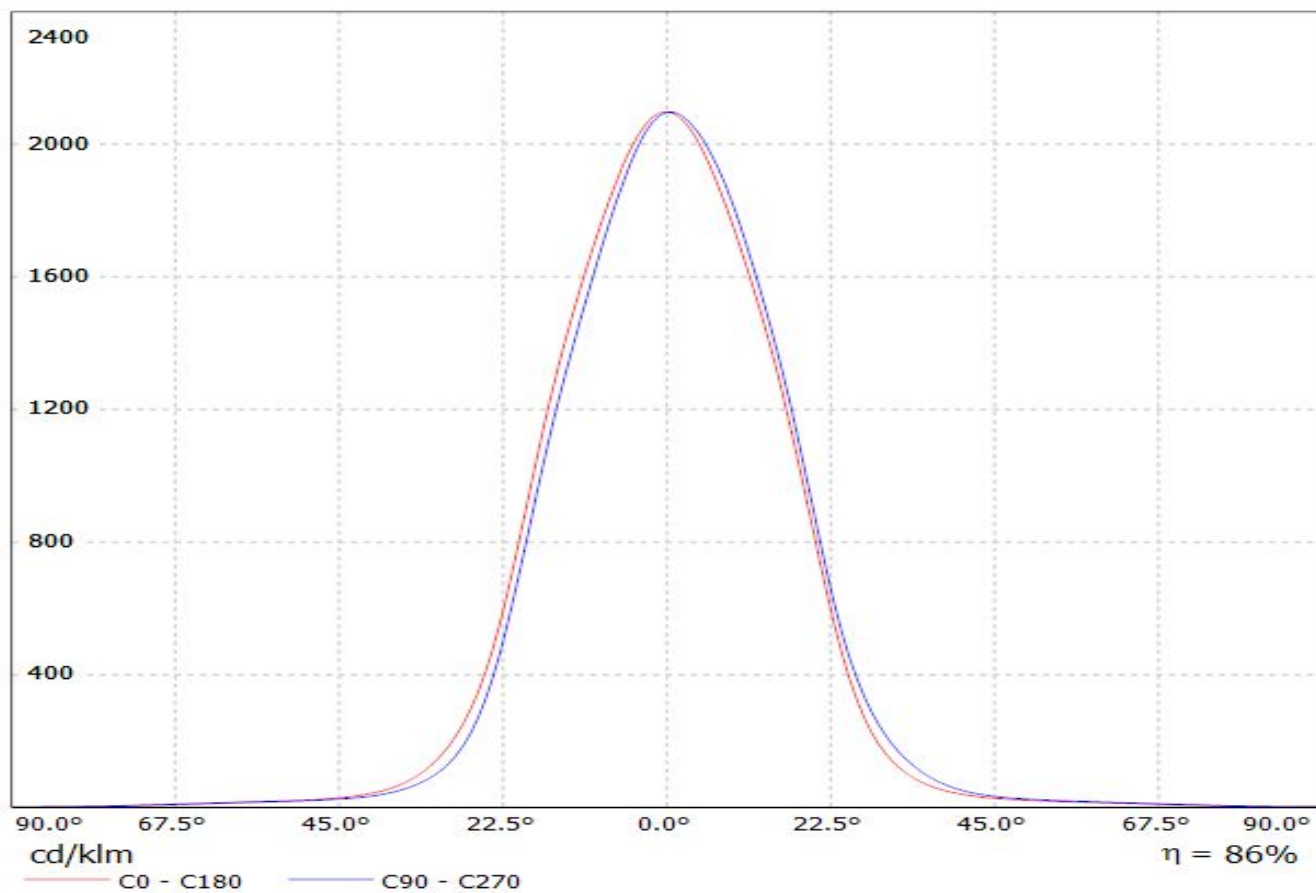

Luminaire: LEDiL Oy FP13031 & FP13025_LISA2-W_(CLIP/PIN) Eff.86.1%
Lamps: 1 x LUXEON_T (74lm@250mA)

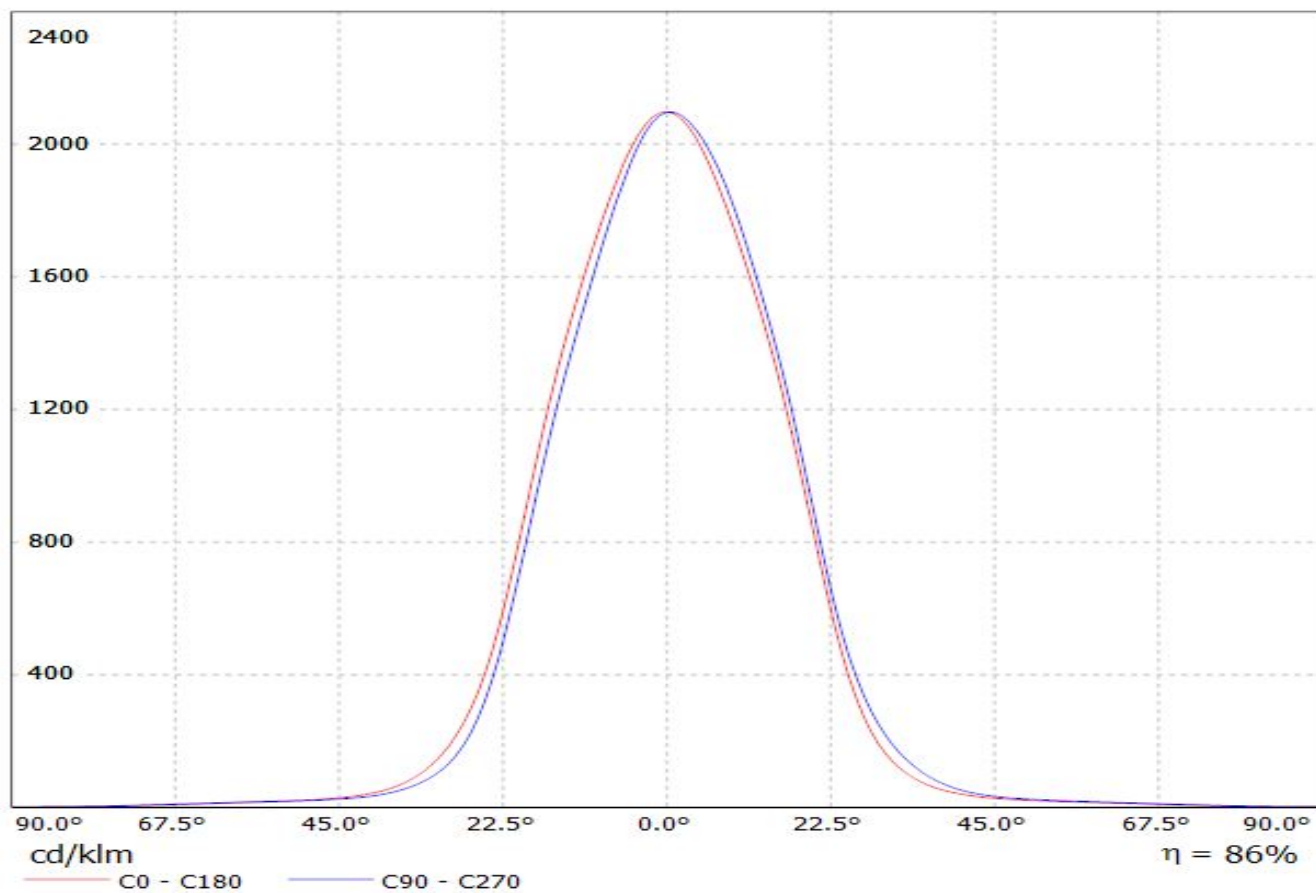

LEDiL Oy C12469_LISA2-R-PIN_(LUXEON_T) Eff.81.8% / LDC (Linear)

Luminaire: LEDiL Oy C12469_LISA2-R-PIN_(LUXEON_T) Eff.81.8%
Lamps: 1 x LUXEON T (74lm@250mA)

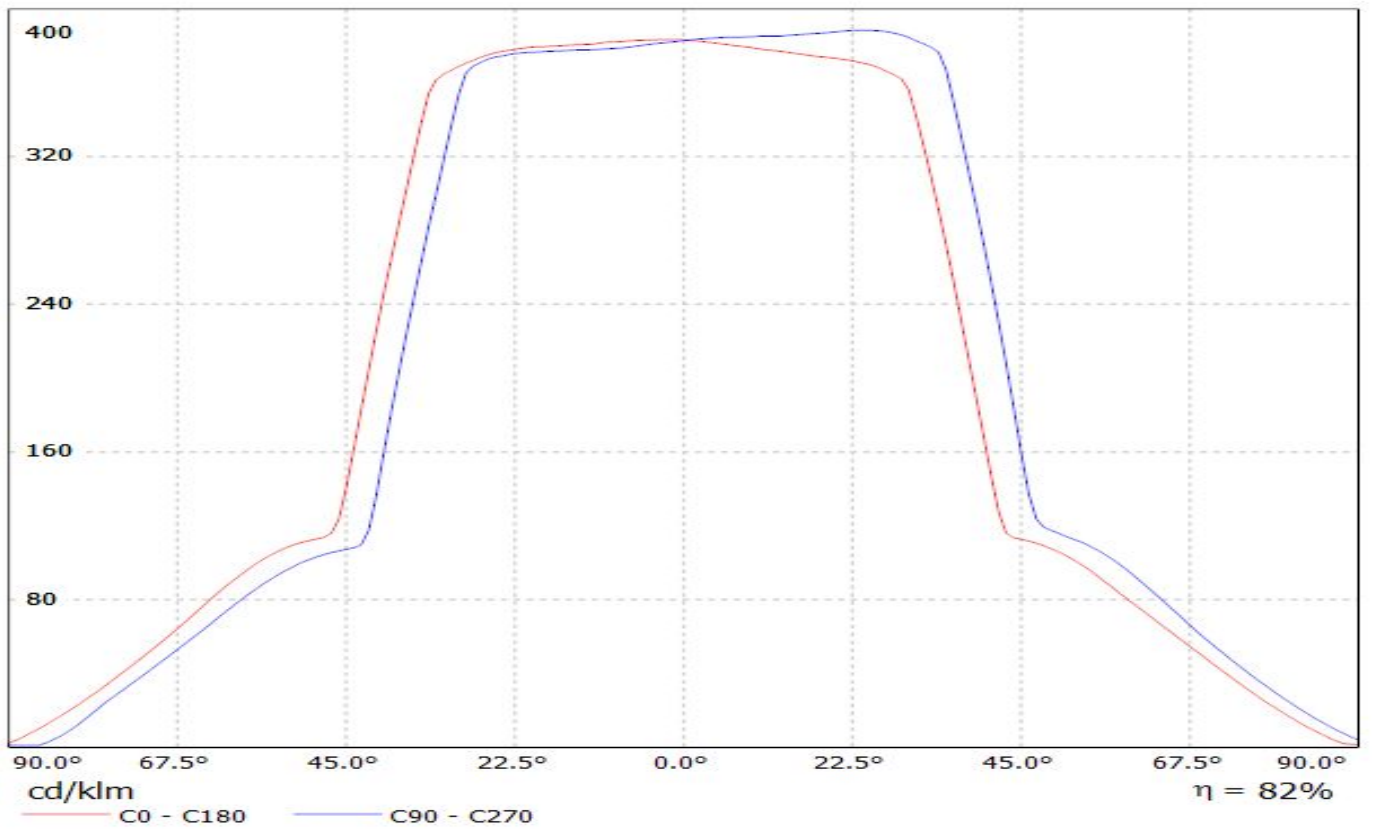

Luminaire: LEDiL Oy FP13030&FP13028_LISA2-M_(CLIP&PIN) Eff.86.6%
Lamps: 1 x LUXEON_T (74lm@250mA)

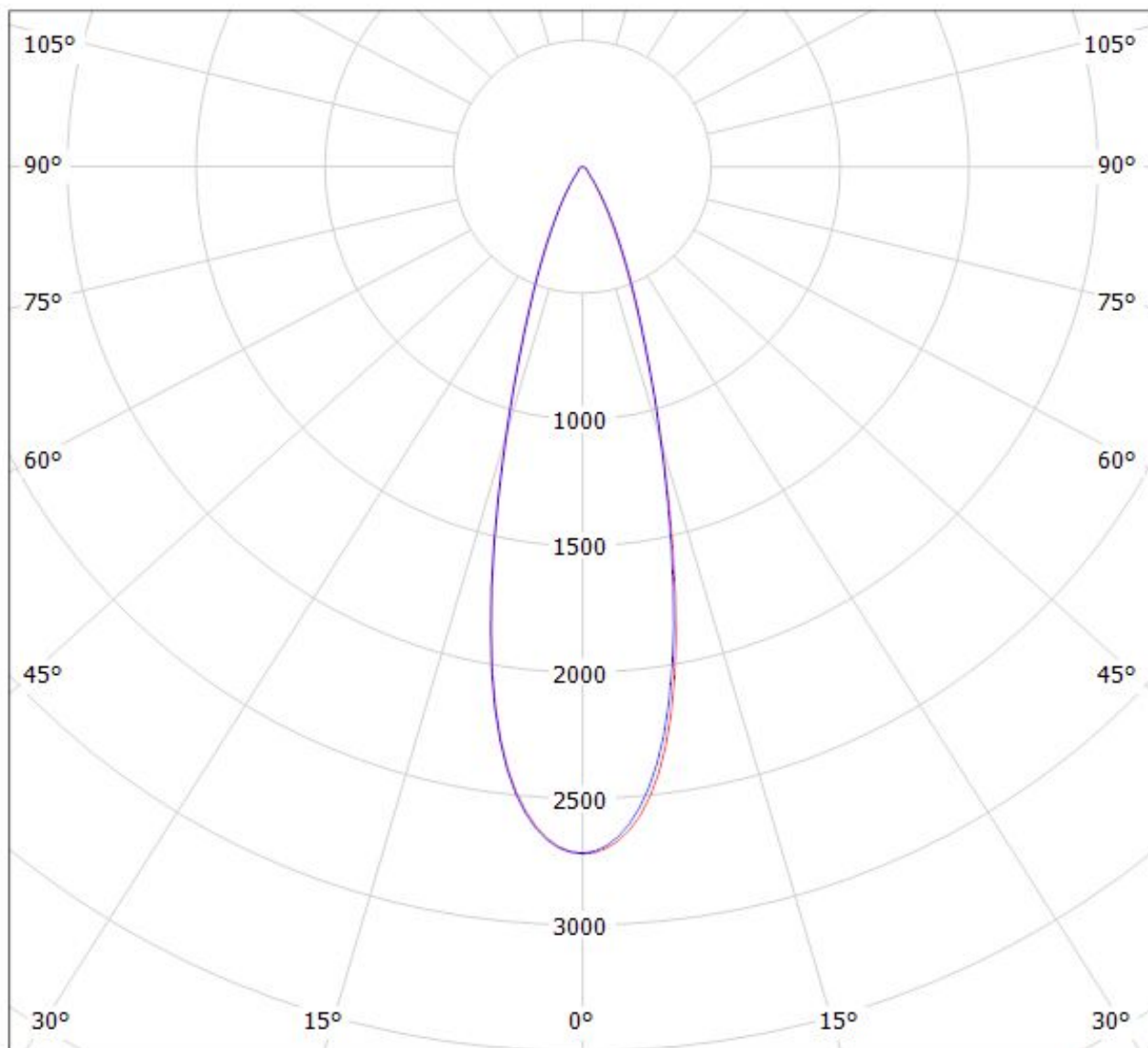

cd/klm

— C0 - C180 — C90 - C270

$\eta = 87\%$

Luminaire: LEDiL Oy FP13030&FP13028_LISA2-M_(CLIP&PIN) Eff.86.6%
Lamps: 1 x LUXEON_T (74lm@250mA)

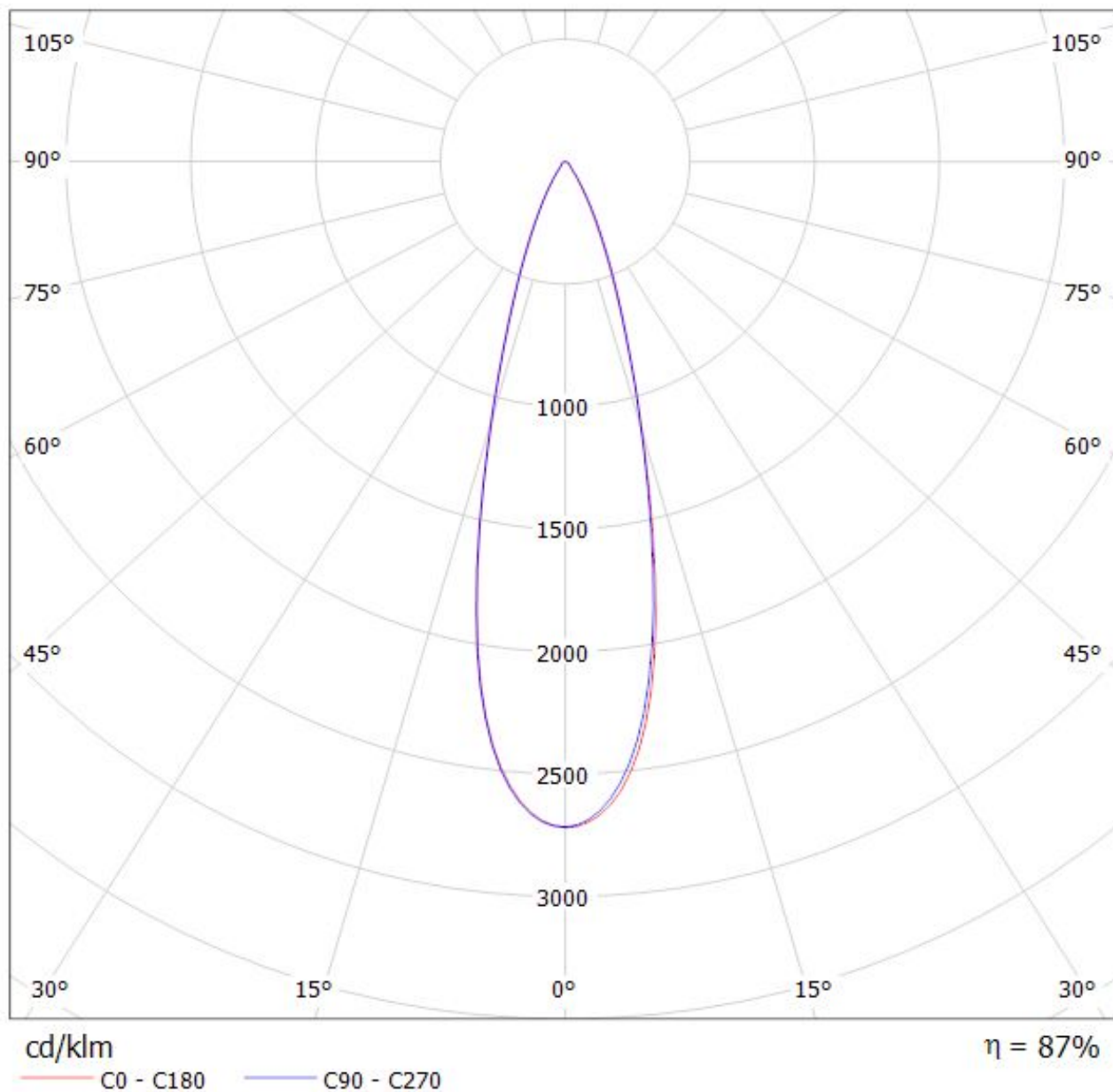

Luminaire: LEDiL Oy FP13031 & FP13025_LISA2-W_(CLIP/PIN) Eff.86.1%
Lamps: 1 x LUXEON_T (74lm@250mA)

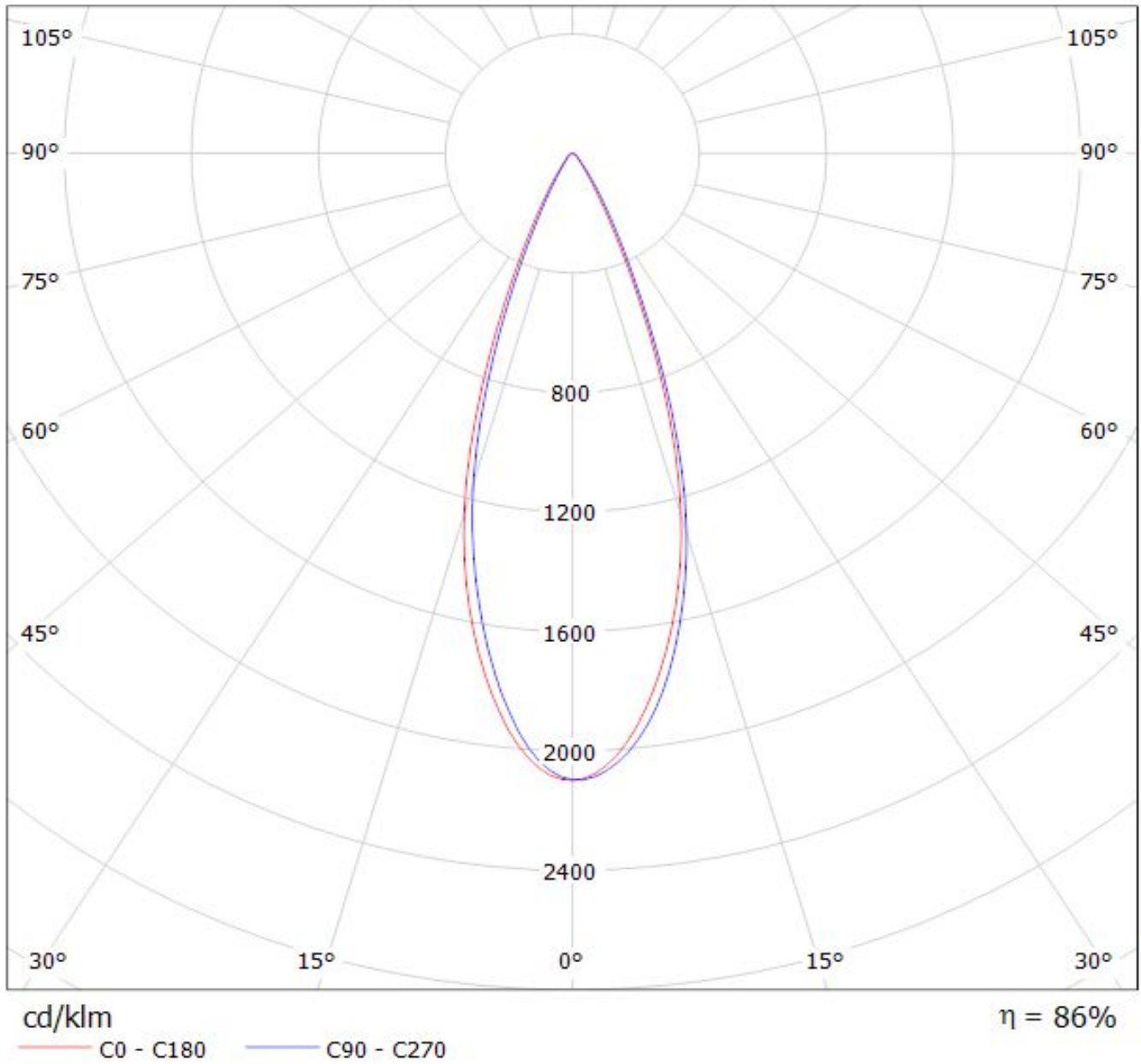

Luminaire: LEDiL Oy FP13031 & FP13025_LISA2-W_(CLIP/PIN) Eff.86.1%
Lamps: 1 x LUXEON_T (74lm@250mA)

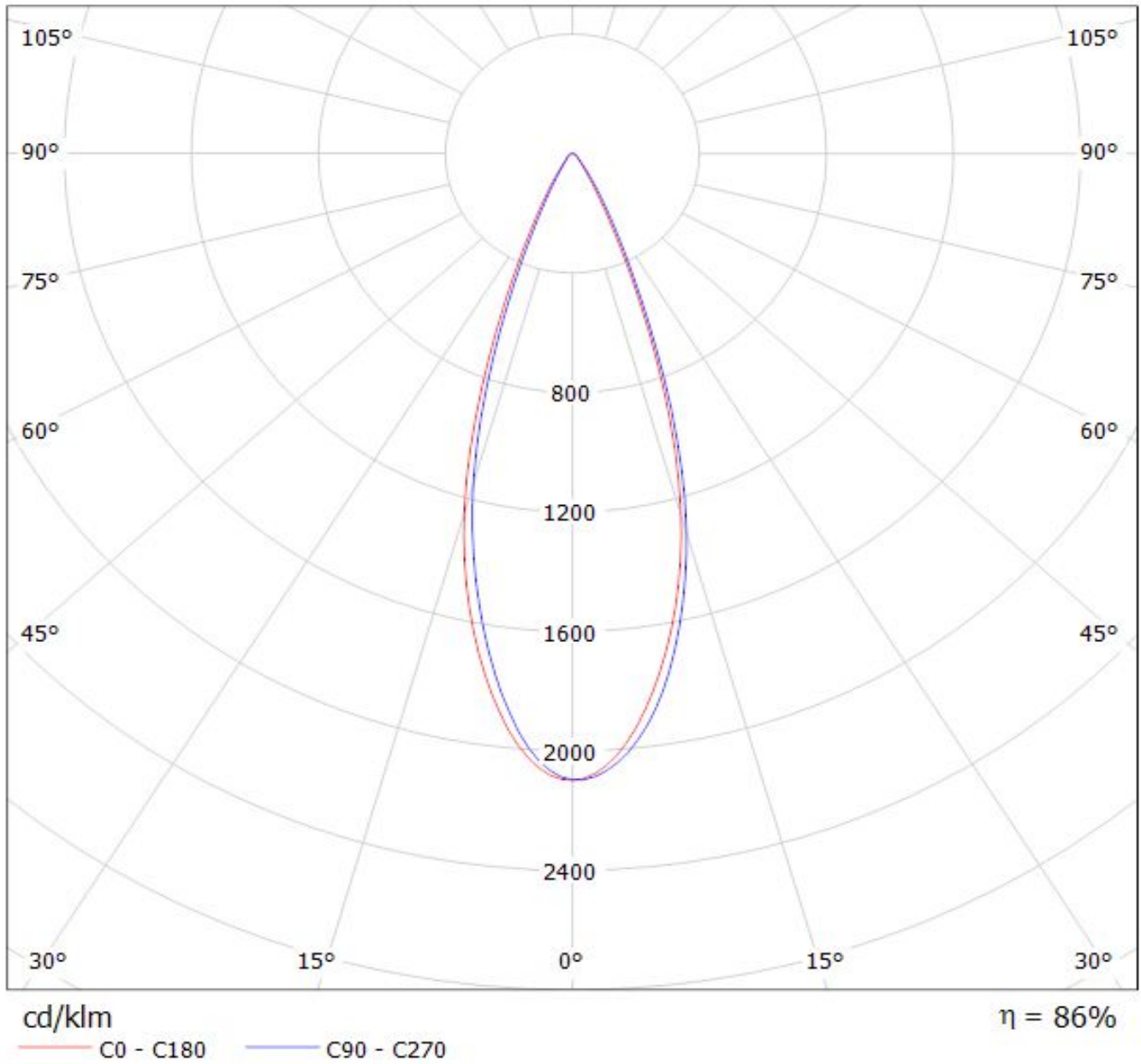

LEDiL Oy C12469_LISA2-R-PIN_(LUXEON_T) Eff.81.8% / LDC (Polar)

Luminaire: LEDiL Oy C12469_LISA2-R-PIN_(LUXEON_T) Eff.81.8%

Lamps: 1 x LUXEON T (74lm@250mA)

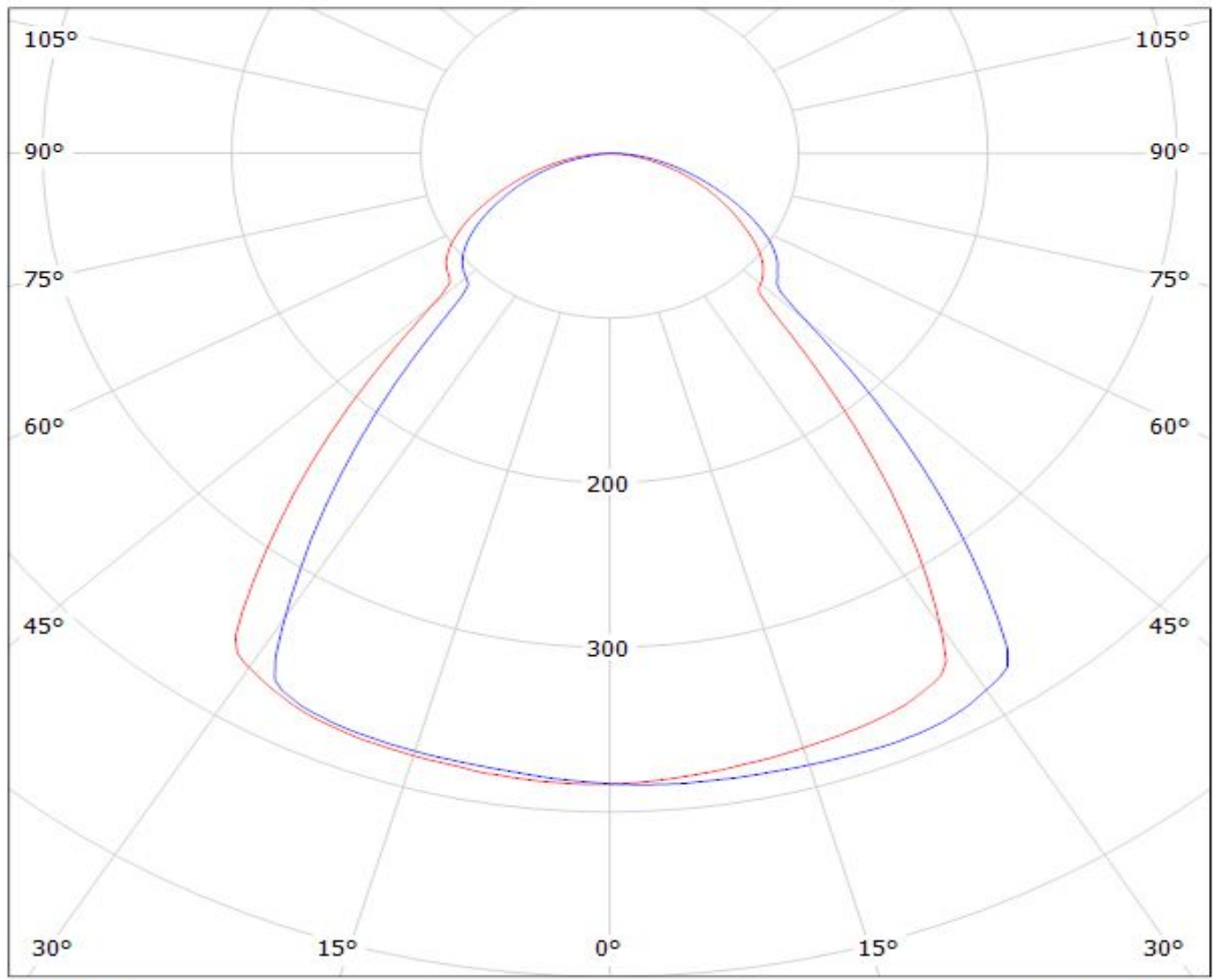

cd/klm

— C0 - C180

— C90 - C270

$\eta = 82\%$