

Solderless terminals

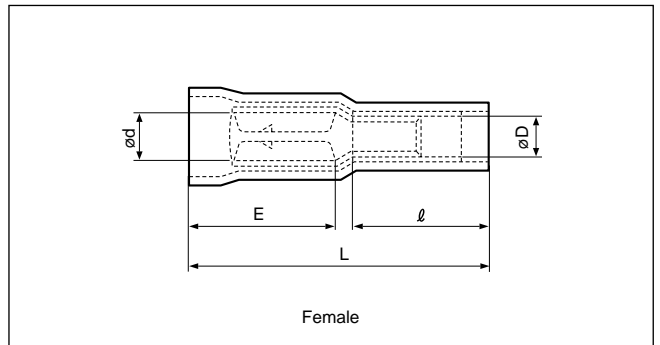

BULLET Vinyl-insulated with copper sleeve

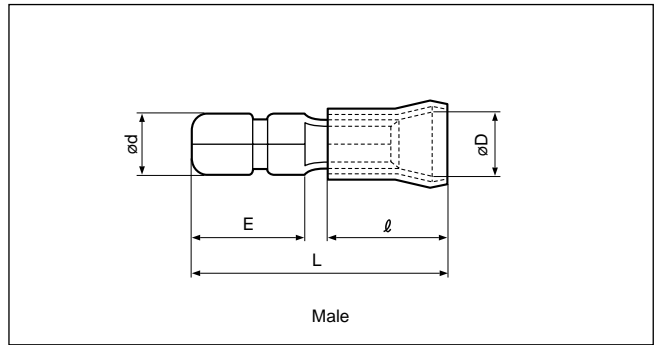
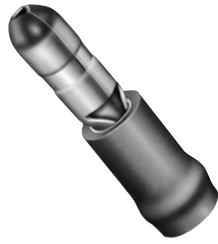

Actual

Refer to page 149 for actual size of the terminal. (except for FVDGM2-5 & CVDGF2-5)

File No.: E42024 LR20812

	Applicable Wire AWG# (mm ²)	Part No.	Standard	Dimensions mm (in.)						Color	Tool No.					Qty/box	
				ø d	L	E	ø D	ℓ	Material Thickness		YNT-2216	YNT-1614	YA-1	YA-2	YA-4		BCT-0514
MALE	22 to 16 (0.25 to 1.65)	FVDGM1.25-5		3.96 (.156)	20.2 (.795)	8.7 (.343)	3.5 (.138)	9.5 (.374)	0.4 (.016)	Red	0	0	0	0	0	0	1,000
	16 to 14 (1.04 to 2.63)	FVDGM2 -5		3.96 (.156)	20.2 (.795)	8.7 (.343)	4.3 (.169)	9.5 (.374)	0.4 (.016)	Blue	0	0	0	0	0	0	1,000
		FVDGM2 -7		4.95 (.195)	20.7 (.815)	8.7 (.343)	4.3 (.169)	9.5 (.374)	0.4 (.016)			0	0	0	0	0	
FEMALE	22 to 16 (0.25 to 1.65)	CVDGF1.25-5		3.96 (.156)	24.0 (.945)	14.0 (.551)	2.7 (.106)	10.0 (.394)	0.4 (.016)	Red	0	0	0	0	0	0	500
	16 to 14 (1.04 to 2.63)	CVDGF2 -5		3.96 (.156)	25.0 (.984)	14.0 (.551)	3.2 (.126)	11.0 (.433)	0.4 (.016)	Blue	0	0	0	0	0	0	500
		CVDGF2 -7		4.95 (.195)	25.0 (.984)	14.0 (.551)	3.2 (.126)	11.0 (.433)	0.4 (.016)			0	0	0	0	0	

Note:1) Delivery lead times may vary depending on the product. Contact JST for details.

Solderless terminals



BULLET (PC Type) Fully-nylon-insulated with copper sleeve

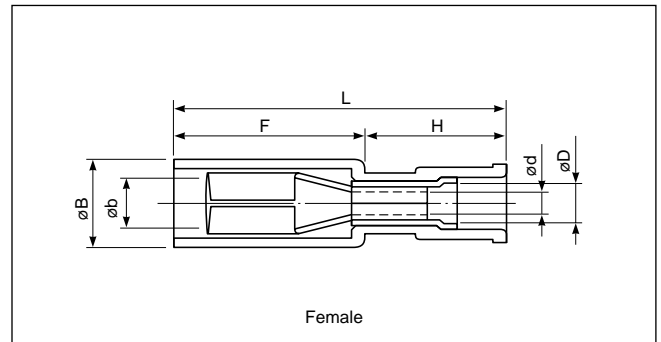
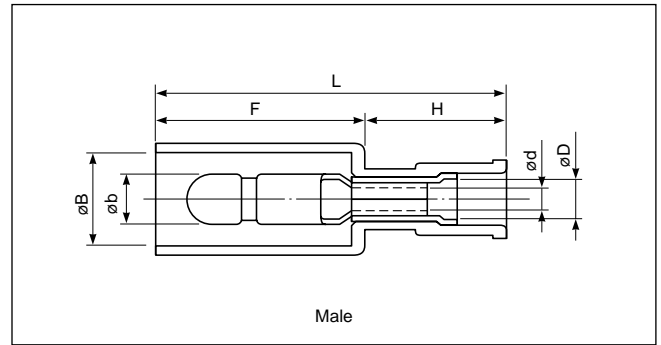

Actual

Refer to page 149 for actual size of the terminal.

File No.: **RA** E42024

	Applicable Wire AWG# (mm ²)	Part No.	Standard	Dimensions mm (in.)								Color	Tool No.						Qty/box
				ø b	ø B	L	F	ø d	ø D	H	Material Thickness		YNT-2216	YNT-1614	YN-2014	YA-1	YA-2	YA-4	
MALE	20 to 18 (0.5 to 0.75)	PCM-0.5	RA	2.0 (.079)	5.1 (.201)	26.5(1.043)	15.0 (.591)	1.7 (.067)	3.1 (.122)	11.5 (.453)	0.3 (.012)	Clear							1,000 (100 x 10)
	18 to 16 (0.75 to 1.25)	PCM-1.25	RA	4.0 (.157)	7.4 (.291)	27.7(1.091)	16.5 (.650)	1.8 (.071)	3.5 (.138)	11.2 (.441)	0.45 (.018)	*Red	0	0	0	0	0	0	
	14 (2.0)	PCM-2	RA	4.0 (.157)	7.4 (.291)	27.7(1.091)	16.5 (.650)	2.4 (.094)	3.9 (.154)	11.2 (.441)	0.45 (.018)	*Blue	0	0	0	0	0	0	
FEMALE	20 to 18 (0.5 to 0.75)	PCF-0.5	RA	2.0 (.079)	4.6 (.181)	24.5 (.965)	13.0 (.512)	1.7 (.067)	3.1 (.122)	11.5 (.453)	0.3 (.012)	Clear			0	0			1,000 (100 x 10)
	18 to 16 (0.75 to 1.25)	PCF-1.25	RA	3.95(.156)	6.9 (.272)	26.2(1.031)	15.0 (.591)	1.8 (.071)	3.5 (.138)	11.2 (.441)	0.45 (.018)	*Red	0		0	0	0	0	
	14 (2.0)	PCF-2	RA	3.95(.156)	6.9 (.272)	26.2(1.031)	15.0 (.591)	2.4 (0.94)	3.9 (.154)	11.2 (.441)	0.45 (.018)	*Blue	0	0	0	0	0	0	

Note: 1) *Clear insulation is also available.

2) Delivery lead times may vary depending on the product. Contact JST for details.