

Legge

DOOR SECURITY RACK BOLT

Features

Bolt

Hardened steel for added security. Zinc plated for corrosion resistance.

Supplied with matching SS or PB escutcheon.

465

Steel key

For greater resistance to wear. To suit doors up to 57mm thick.

Stainless steel:

SS.

Polished Brass:

PB.

Powder coated black.

(B) Box packed: 12 per box.

(P) Prepack: 6 per box.

464

465

Finishes/Materials

Forend/locking plate

Steel case

Packaging

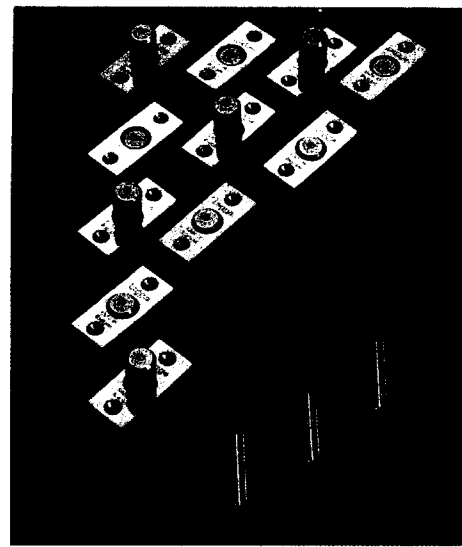

Door Security Rack Bolt

464

Code

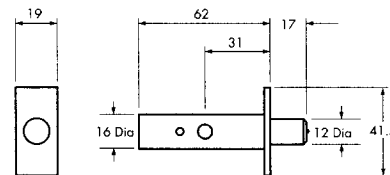
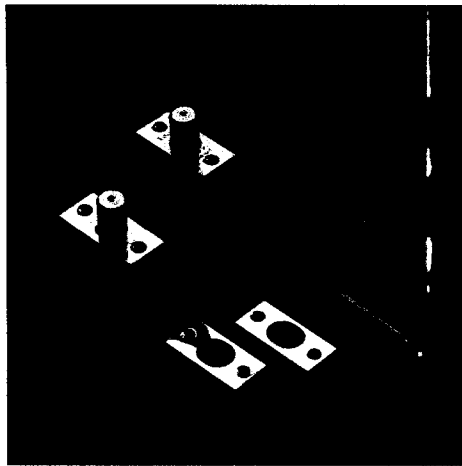

Finish/Features

605

Brass polished and lacquered (PB).
Wood screw fixing.

Sizes

19mm, 26mm, 32mm, 38mm.

610

Brass polished and lacquered (PB).
Bolt fixing (length 38mm).

Sizes

26mm, 32mm, 38mm

614

Brass polished and lacquered (PB).
Bolt fixing (length 45mm).

Size

32mm.

Packaging

(B) Box packed: 20 per box.

(P) Prepack: 6 pairs per box.

(614: Prepacked 6 per box).

Matching door knob sets 326 or 472.



Top

605 x 4 Sizes

Middle

610 x 3 Sizes

Bottom

614

