

| SYMBOL DEFINITION | | MISSING SYMBOLS | |
|--|----------------------------------|--------------------------|----|
| A DIMENSION WITHOUT AN INSPECTION REPORT SYMBOL () DOES NOT REQUIRE INSPECTION. IT MAY BE CONTROLLED ON THE INDIVIDUAL COMPONENT DRAWING. | TOTAL NO OF INSPECTIONS REQUIRED | NO MISSING SYMBOL NUMBER | 16 |
| | LAST NO. USED | | 16 |

| DWG STATUS | | | | ZONE | REVISION HISTORY | AUTH | DR | APVD1 | APVD2 |
|------------|-----|-----|-----|------|--|--------|-----|-------|-------|
| DATE | STG | REV | N/P | | | | | | |
| 15AU01 | R | 06 | - | - | ALL PARTS - REVISED MAT'L SIZE AND MAT'L SPEC | 211578 | ESF | EAR | GMC |
| 18SE03 | R | 07 | - | - | 12129484 - UPDATED PDM ATTRIBUTES 12129373 - UPDATED PDM ATTRIBUTES | 245985 | ADK | BB | TM |
| 17FE04 | R | 08 | - | - | ALL PARTS - T.Q.D. UPDATED | 250621 | JS | JS | B0 |
| 150C04 | R | 09 | - | - | ALL PARTS - ADDED TERMINAL ID NOTE AND REMOVED PXX FROM GRAPHICS | 260003 | CTR | JAA | MKM |
| 24MR05 | R | 10 | - | - | 13525297 - RELEASED | 266174 | DAD | DAD | AGL |
| 15SE05 | R | 11 | - | - | UPDATED PDM ATTRIBUTES | 272396 | JTZ | FKV | BDG |
| 27SE05 | R | 12 | - | - | 15317769, 12129484 & 12129373 - ADDED EXCLUDING COIN TO DIM 13 | 269136 | RTV | JMV | MKM |

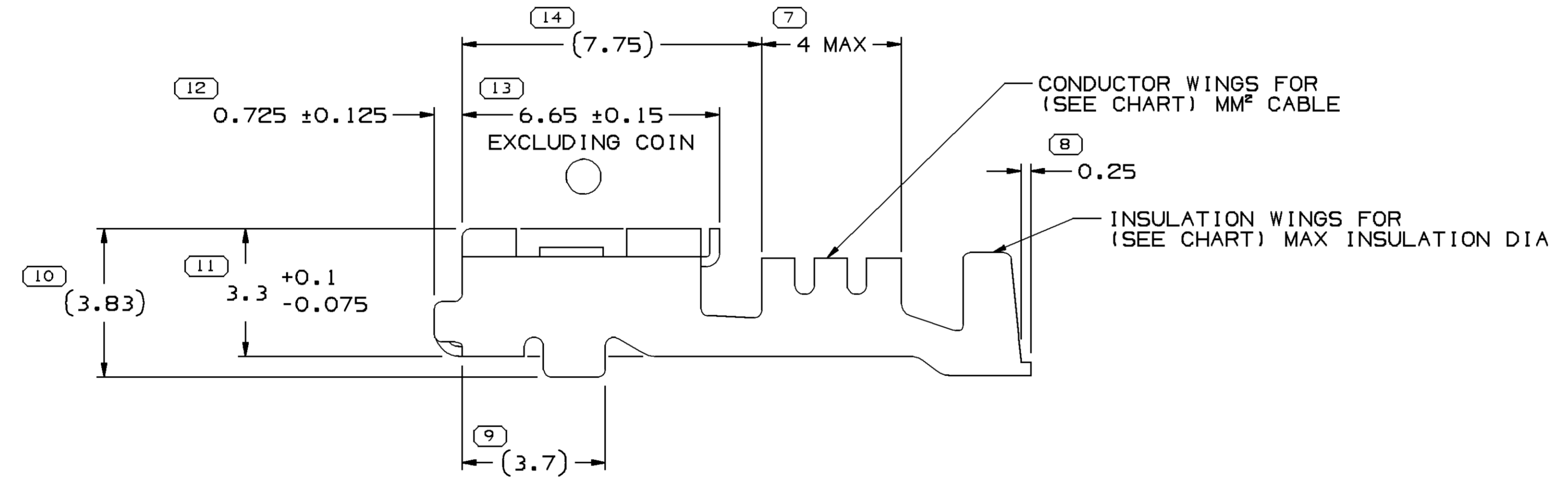
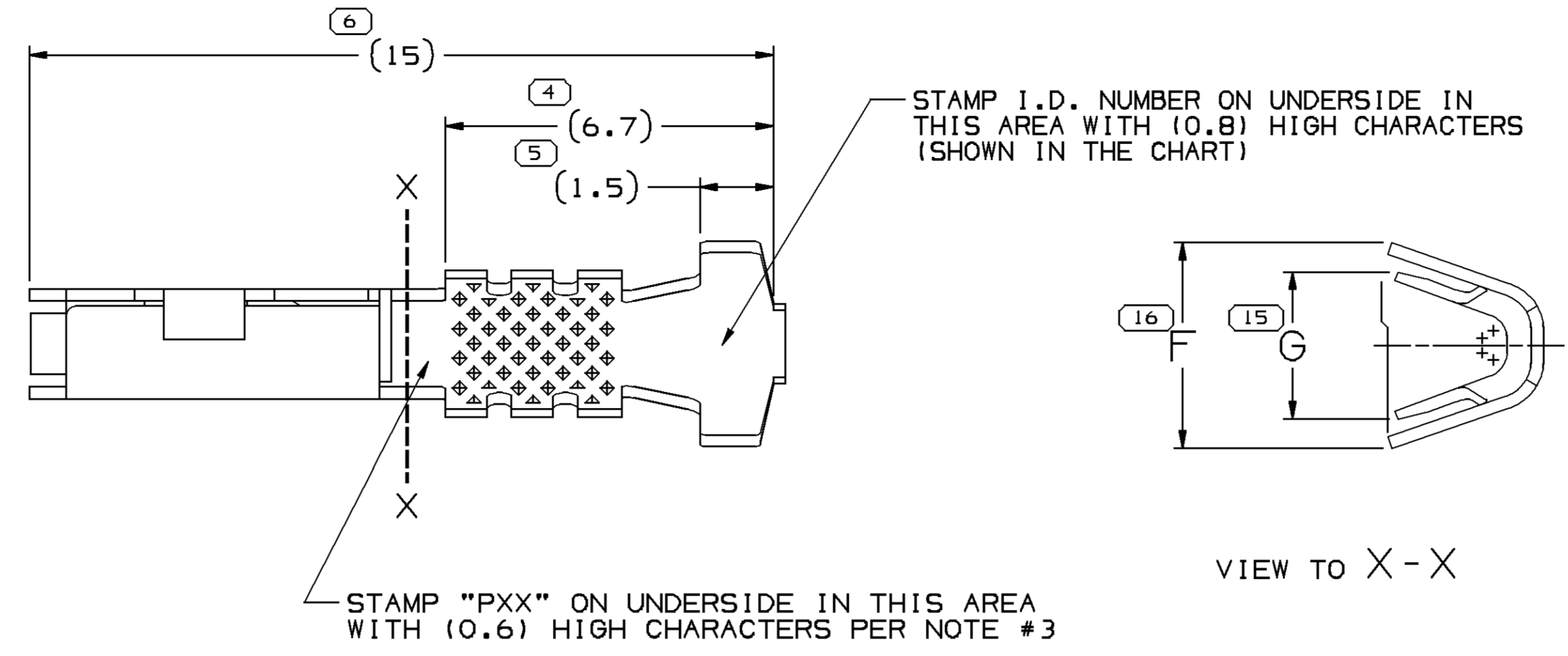
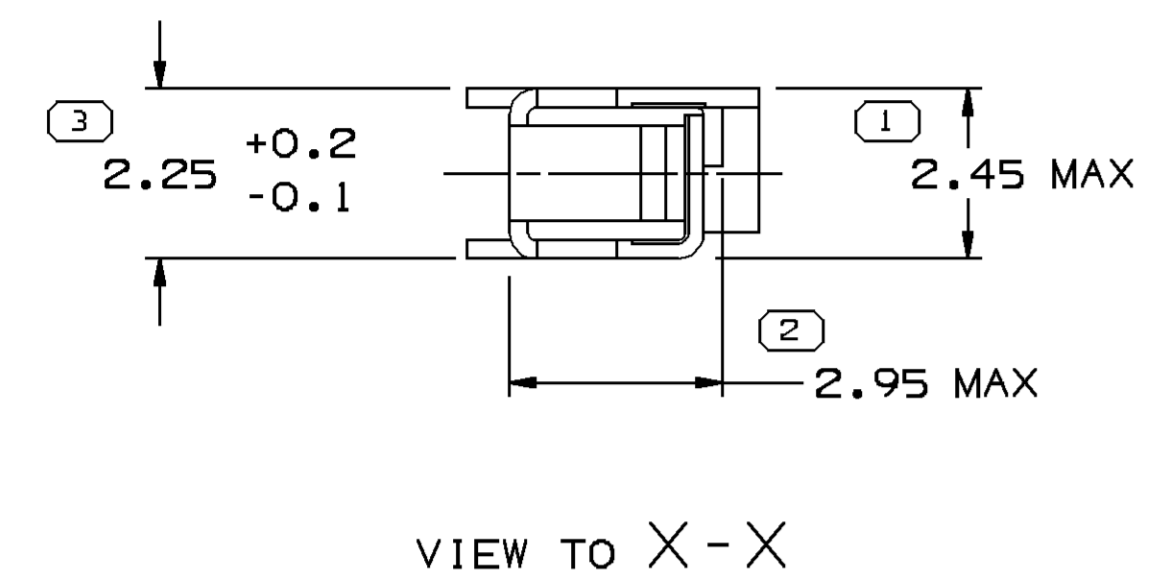

- NOTES:
- UNLESS OTHERWISE SPECIFIED AND/OR INDICATED:
DIMENSIONS ARE TO FACE OF VIEW SHOWN AND AUTOMATICALLY ROUNDED BY COMPUTER FOR INSPECTION (SEE MATH MODEL FOR PRECISE DIMENSIONS). FOR ALL OTHER DIMENSIONS NOT SHOWN BUT REQUIRED FOR TOOL BUILD, SEE MATH MODEL FOR PRECISE TOOL PATH DATA.
 - RECOMMENDED MATING BLADE- WIDTH 1.52±0.12, THICKNESS 0.825±0.035, LENGTH 7±0.1
 - "PXX" INDICATES "P" PLUS LAST TWO DIGITS OF MAKE DIE SERIES NUMBER (P01, P02, P03, ETC).

| PART NO. | REV | STATUS | MAT'L SIZE | PART NO. | REV | N/P | STATUS | MAT'L SPEC. | SIZE MM² | I.D. | DIA. | TYPE | F | G±0.2 |
|----------|-----|--------|------------|----------|-----|-----|--------|-------------------------------------|----------|-------|----------|------|---------|-------|
| | | | 0.254 X 29 | 13525297 | 01 | | | M3620LN1 654 SLZ BRZ 1/2 HD AU PLTD | 0.5-0.35 | 21 | 2.2-1.3 | 101 | 3.5±0.3 | 2.1 |
| | | | 0.254 X 29 | 15317769 | 04 | AB | | M3606A59 654 SLZ BRZ 1/2 HD SN PLTD | 0.5-0.35 | 21 | 1.3-1.1 | 101 | 2.25 | 2.1 |
| | | | 0.254 X 29 | 12129484 | 05 | AB | | M3606A59 654 SLZ BRZ 1/2 HD SN PLTD | 1-0.8 | 17 | 2.4-2.03 | 101 | 4.2±0.2 | 3 |
| | | | 0.254 X 29 | 12129373 | 05 | AB | | M3606A59 654 SLZ BRZ 1/2 HD SN PLTD | 0.5-0.35 | 21 | 2.2-1.3 | 101 | 3.5±0.3 | 2.1 |
| | | | UNPLATED | | | | PLATED | | | CABLE | | | | |

DWG TYPE: PART DRAWING

STYLE: [Symbol]

VOLUME (QTY): [Symbol] DISTR CODE: [Symbol]

UNLESS OTHERWISE SPECIFIED THIS DOCUMENT IS IN ACCORDANCE WITH ASME Y14.5M-1994 AS AMENDED BY THE 3M GLOBAL DIMENSIONING AND TOLERANCING ADDENDUM-2001. SEPARATE PATTERNS OF FEATURES MAY BE DAGED SEPARATELY REGARDLESS OF DATUM REFERENCES.

ALL DIMENSIONS ARE IN MILLIMETERS

REFERENCE:

THIRD ANGLE PROJECTION

DO NOT SCALE USE MATH DATA

UNIGRAPHICS

DELPHI
DELPHI PACKARD ELECTRIC SYSTEMS
WARREN, OH

| | |
|--------------------|--------|
| DR | DATE |
| APVD1 RUBEN ORTIZ | 23N096 |
| APVD2 ENRIQUE SAEZ | 25N096 |
| APVD3 B. GROUBERT | 17FE04 |
| APVD4 | |
| APVD5 | |

SUBSTANCES OF CONCERN AND RECYCLED CONTENT PER DELPHI 10949001

MATERIAL SEE CHART

DRAWING NAME: TAXI TERM F M/P 150

DRAWING NUMBER: 12129483

| | | | | | | |
|------|-------|----------|----------|-----|-----|-----|
| SIZE | SCALE | FRAME NO | SHEET NO | STG | REV | N/P |
| A1 | 10:1 | 1 OF 1 | 1 OF 1 | R | 12 | - |

| | |
|--|---------|
| (N/A) PROCESS SENSITIVE DIMENSION | |
| DIMENSIONS ENCLOSED IN () INDICATE REFERENCE DIMENSIONS AND NO TOLERANCE LIMITS ARE ESTABLISHED | |
| DIMENSIONAL RANGE (MM) | CHART D |
| FROM 0 | >12 |
| TO 12 | |
| TOLERANCE UNLESS OTHERWISE SPECIFIED | |
| ±0.1 | ±0.2 |
| ANGULAR TOLERANCE ±2° | |