

Instrument cases/system enclosures

Rittal RiCase 269.2 mm (1/2 19")

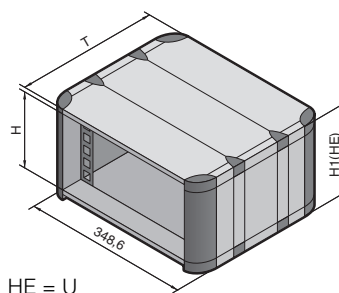

HE = U

Technical specifications:

Depth:
300 mm, 420 mm, 540 mm
Installation width:
269.2 mm (1/2 19")
Installation options:
269.2 mm (1/2 19") slide-in
equipment and modular assem-
blies to IEC 60 297-3

Material/surface finish:

Covers: Extruded aluminium
section/die-cast, spray-finished
Side panels: Extruded aluminium
section, spray-finished
Corner caps: Plastic
482.6 mm (19") mounting
bracket: Extruded aluminium
section, clear-chromated

Colour:

RAL 7035 (pale grey)

Decorative colours and corner caps:

RAL 5018 (turquoise)
RAL 5012 (pale blue)
RAL 7030 (stone grey)

Protection category:

IP 42 for unvented version.

Supply includes:

2 side panels,
2 covers,
8 corner caps,
8/12/16 cover caps
(300/420/540 mm depth),
4 482.6 mm (19") mounting
brackets,
4 tapped strips,
2 untapped strips,
1 rear wall
Enclosures are supplied partially
assembled.

Special sizes and colours available on request.

Property rights:

German registered design
no. 96 09 457
IR Reg. Design no. DM/039 974
with validity for FR, IT
UK reg. design no. 2064682
US Design Patents
Des. 402,640 and Des. 423,464
Japan. Reg. Designs
No. 1045507 and 1045508

Detailed drawing, see page 1161.

Enclosures for subrack width 269.2 mm (1/2 19")	Packs of	1 U		2 U		3 U			4 U		Page
Height (H) in mm		77.5	77.5	121.9	121.9	166.4	166.4	166.4	210.8	210.8	
H1 (U) in mm		45.0	45.0	89.4	89.4	133.8	133.8	133.8	178.3	178.3	
Depth (T) in mm		300.0	420.0	300.0	540.0	300.0	420.0	540.0	420.0	540.0	
Unvented											
Model No. RC, RAL 5018 ¹⁾	1	3750.100	–	3750.200	–	3750.210	3750.300	–	3750.400	–	
Model No. RC, RAL 5012 ¹⁾	1	3750.102	–	3750.202	–	3750.212	3750.302	–	3750.402	–	
Model No. RC, RAL 7030	1	3750.104	–	3750.204	–	3750.214	3750.304	–	3750.404	–	
Vented											
Model No. RC, RAL 5018 ¹⁾	1	–	3750.110	–	3750.220	–	3750.350	3750.360	–	3750.450	
Model No. RC, RAL 5012 ¹⁾	1	–	3750.112	–	3750.222	–	3750.352	3750.362	–	3750.452	
Model No. RC, RAL 7030	1	–	3750.114	–	3750.224	–	3750.354	3750.364	–	3750.454	
Weight (kg)	Vented/ unvented	3.3 3.4	4.2 4.4	3.7 3.8	5.4 6.1	4.1 4.2	5.2 5.4	6.1 6.8	5.8 6.0	6.8 7.5	
Accessories											
Carrying handles, horizontal	2	3751.250	3751.260	3751.250	3751.270	3751.250	3751.260	3751.270	3751.260	3751.270	565
Support stand/ carrying handle	RAL 5018 ¹⁾	1	3751.200	3751.200	3751.200	3751.200	3751.200	3751.200	3751.200	3751.200	566
	RAL 5012 ¹⁾	1	3751.202	3751.202	3751.202	3751.202	3751.202	3751.202	3751.202	3751.202	566
	RAL 7030	1	3751.204	3751.204	3751.204	3751.204	3751.204	3751.204	3751.204	3751.204	566
Blanking plates (rear panel)	3	3746.000	3746.000	3747.000	3747.000	3748.000	3748.000	3748.000	3749.000	3749.000	1013
Front door, vertically hinged	1	–	–	–	–	3751.300	3751.300	3751.300	3751.300	3751.300	566
Slide rails	2	3751.500	3751.510	3751.500	3751.520	3751.500	3751.510	3751.520	3751.510	3751.520	565
Mounting bracket 482.6 mm (19")	2	3751.650	3751.650	3751.660	3751.660	3751.670	3751.670	3751.670	3751.680	3751.680	564
Tapped strips with M4 thread	8	3751.700	3751.700	3751.710	3751.710	3751.720	3751.720	3751.720	3751.730	3751.730	564
End section	2	–	–	–	–	3751.900	3751.900	3751.900	3751.910	3751.910	565

¹⁾ Extended delivery times.

Instrument cases/system enclosures

Rittal RiCase 482.6 mm (19")

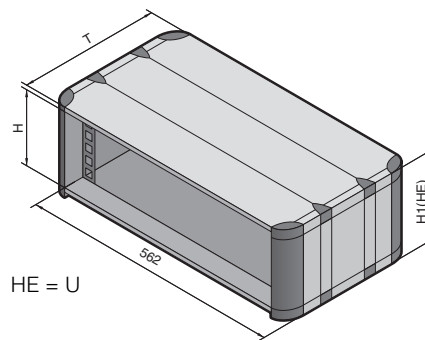
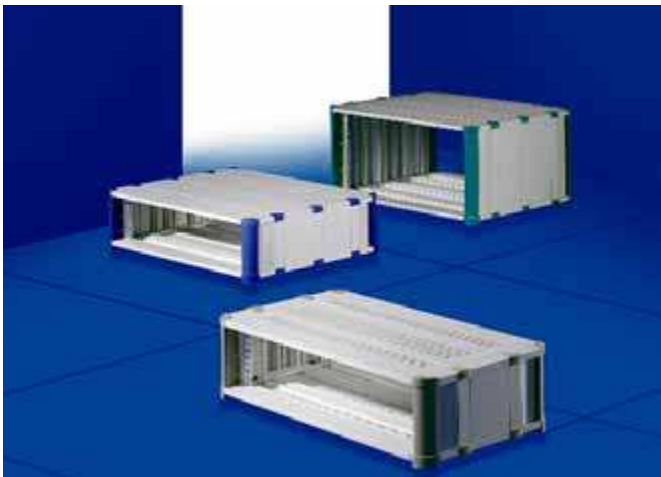

Technical specifications:

Depth:
300 mm, 420 mm, 540 mm
Installation width:
482.6 mm (19")
Installation options:
482.6 mm (19") slide-in equipment and modular assemblies to IEC 60 297-3

Material/surface finish:

Covers: Extruded aluminium section/die-cast, spray-finished
Side panels: Extruded aluminium section, spray-finished
Corner caps: Plastic
482.6 mm (19") mounting bracket: Extruded aluminium section, clear-chromated

Colour:

RAL 7035 (pale grey)

Decorative colours and corner caps:

RAL 5018 (turquoise)
RAL 5012 (pale blue)
RAL 7030 (stone grey)

Protection category:

IP 42 for unvented version.

Supply includes:

2 side panels,
2 covers,
8 corner caps,
8/12/16 cover caps
(300/420/540 mm depth),
2 482.6 mm (19") mounting brackets,
2 tapped strips,
2 untapped strips,
enclosures are supplied partially assembled.

Note:

For rear installation, order back panel/door separately.

Special sizes and colours available on request.

Detailed drawing, see page 1161.

Enclosures for subrack width 482.6 mm (19")	P. of	3 U		4 U		6 U		7 U		9 U		12 U	Page
Height (H) in mm		166.4	166.4	210.8	210.8	299.7	299.7	299.7	344.2	344.2	433.1	433.1	566.5
H1 (U) in mm		133.8	133.8	178.3	178.3	267.2	267.2	267.2	311.7	311.7	400.6	400.6	534.0
Depth (T) in mm		300.0	420.0	300.	420.	300.0	420.0	540.0	420.0	540.0	420.0	540.0	540.0
Unvented													
Model No. RC, RAL 5018 ¹⁾	1	3750.310	3750.320	3750.410	3750.420	3750.600	3750.610	3750.620	3750.700	3750.710	3750.900	3750.910	3750.000
Model No. RC, RAL 5012 ¹⁾	1	3750.312	3750.322	3750.412	3750.422	3750.602	3750.612	3750.622	3750.702	3750.712	3750.902	3750.912	3750.002
Model No. RC, RAL 7030	1	3750.314	3750.324	3750.414	3750.424	3750.604	3750.614	3750.624	3750.704	3750.714	3750.904	3750.914	3750.004
Vented													
Model No. RC, RAL 5018 ¹⁾	1	3750.330	3750.340	3750.430	3750.440	3750.630	3750.640	3750.650	3750.720	3750.730	3750.920	3750.930	3750.030
Model No. RC, RAL 5012 ¹⁾	1	3750.332	3750.342	3750.432	3750.442	3750.632	3750.642	3750.652	3750.722	3750.732	3750.922	3750.932	3750.032
Model No. RC, RAL 7030	1	3750.334	3750.344	3750.434	3750.444	3750.634	3750.644	3750.654	3750.724	3750.734	3750.924	3750.934	3750.034
Weight (kg)	Vented/ unvented	5.3 5.4	6.9 7.1	5.7 7.2	7.5 7.7	6.5 6.6	8.5 8.7	10.8 12.2	9.1 9.3	11.5 12.9	10.1 10.3	12.9 14.3	15.0 16.4

Accessories

Carrying handles, horizontal	2	3751.250	3751.260	3751.250	3751.260	3751.250	3751.260	3751.270	3751.260	3751.270	3751.260	3751.270	3751.270	565
Support stand/carrying handle	RAL 5018 ¹⁾	1	3751.210	3751.210	3751.210	3751.210	3751.210	3751.210	3751.210	3751.210	3751.210	3751.210	3751.210	566
	RAL 5012 ¹⁾	1	3751.212	3751.212	3751.212	3751.212	3751.212	3751.212	3751.212	3751.212	3751.212	3751.212	3751.212	566
	RAL 7030	1	3751.214	3751.214	3751.214	3751.214	3751.214	3751.214	3751.214	3751.214	3751.214	3751.214	3751.214	566
Back panel, screw-fastened	1	3751.600	3751.600	3751.610	3751.610	3751.620	3751.620	3751.620	3751.630	3751.630	3751.530	3751.530	3751.540	568
Rear door, vertically hinged	1	3751.100	3751.100	3751.110	3751.110	3751.120	3751.120	3751.120	3751.130	3751.130	-	-	-	568
Rear door for fan installation	1	3751.150	3751.150	3751.160	3751.160	3751.170	3751.170	3751.170	3751.180	3751.180	-	-	-	568
Front door, vertically hinged	1	3751.320	3751.320	3751.330	3751.330	3751.340	3751.340	3751.340	3751.350	3751.350	-	-	-	566
Slide rails	2	3751.500	3751.510	3751.500	3751.510	3751.500	3751.510	3751.520	3751.510	3751.520	3751.510	3751.510	3751.520	565
Mounting angles 482.6 mm (19")	2	3751.670	3751.670	3751.680	3751.680	3751.690	3751.690	3751.690	3751.640	3751.640	3751.780	3751.780	3751.790	564
Slide-in strips with M4 thread	8	3751.720	3751.720	3751.730	3751.730	3751.740	3751.740	3751.740	3751.750	3751.750	3751.760	3751.760	3751.770	564
End section	2	3751.900	3751.900	3751.910	3751.910	3751.920	3751.920	3751.920	3751.930	3751.930	3751.820	3751.820	3751.830	565

¹⁾ Extended delivery times.

Instrument cases/system enclosures

Rittal RiCase accessories



Mounting angles 482.6 mm (19")

For front/rear installation of subracks and blanking plates.

Material:

Extruded aluminium section, clear-chromated

Supply includes:

Assembly parts.

Note:

1 pack of tapped strips and 2 packs of mounting rails and spacers are required for depth-adjustable installation.

For enclosure height	Packs of	Model No. RC
1 U	2	3751.650
2 U	2	3751.660
3 U	2	3751.670
4 U	2	3751.680
6 U	2	3751.690
7 U	2	3751.640
9 U	2	3751.780
12 U	2	3751.790

! Also required:

Slide-in strips, see page 564.
Mounting rails, see page 564.
Spacers, see page 564.



Threaded inserts

with M4 thread
for RiCase, Vario-Case iS

For the installation of mounting brackets, slide rails, mounting kits, cable ducts etc. Simply slide into the channels in the side panels.

Material:

Extruded aluminium section, clear-chromated

For enclosure height	Packs of	Model No. RC
1 U	8	3751.700
2 U	8	3751.710
3 U	8	3751.720
4 U	8	3751.730
6 U	8	3751.740
7 U	8	3751.750
9 U	8	3751.760
12 U	8	3751.770



Mounting rails

- For depth-variable installation of mounting angles
- For the installation of component shelves, static or pull-out

Material:

Aluminium, clear-chromated

Supply includes:

Assembly parts.

- A** Version for depth-variable mounting angles
- B** Component shelf installation for 482.6 mm/19" (width 409 mm, also with telescopic slides)
- C** Direct component shelf installation (width 471 mm)

- 1** Slide-in strips
- 2** Short spacers
- 3** Long spacers
- 4** Mounting rails

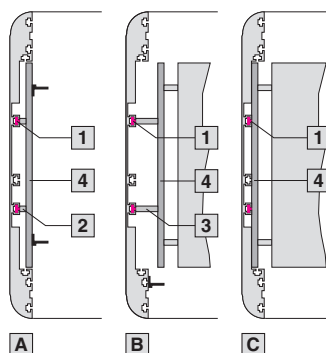

For enclosure depth mm	Packs of	Model No. RC
420	2	3751.410
540	2	3751.420

! Also required:

Threaded inserts, see page 564.
Spacers, see page 564.

+ Accessories:

Component shelf, see page 944.
Component shelf, 482.6 mm (19"), see page 939.



Spacers

For the attachment of mounting rails.

Version	Packs of	Model No. RC
Short for depth-variable mounting bracket	4	3751.450
Long for component shelf installation (width 409 mm)	4	3751.460



Slide rails

To support heavy installed equipment.

Material:

1.5 mm sheet steel, zinc-plated, passivated

Supply includes:

Assembly parts.

For enclosure depth mm	Packs of	Model No. RC
300	2	3751.500
420	2	3751.510
540	2	3751.520



Also required:

Threaded inserts, see page 564.



Earthing set

for RiCase, Vario-Case iS

To meet electrical protective measures; fits all RiCase and Vario-Case iS enclosures.

Supply includes:

Threaded insert, screw, green/yellow connection cable, serrated washer, nut.

Packs of	Model No. VC
4	3798.000



Rear trim

To cover the sides to the left and right of the sub-rack when no rear door or rear panel is used.

Material:

Extruded aluminium section, spray-finished

Colour:

RAL 7035

Supply includes:

Assembly parts.

For enclosure height	Packs of	Model No. RC
3 U	2	3751.900
4 U	2	3751.910
6 U	2	3751.920
7 U	2	3751.930
9 U	2	3751.820
12 U	2	3751.830

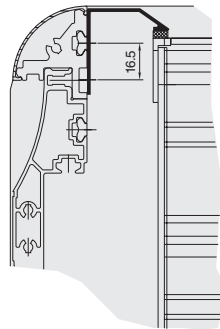

Carrying handles

horizontal

For easy, secure transportation.

- May be retrofitted
- Load capacity 30 kg/pair

Material:

Side parts: Die-cast, spray-finished
Centre part: Extruded aluminium section, spray-finished

Colour:

RAL 7035

Supply includes:

Assembly parts.

For enclosure depth mm	Packs of	Model No. RC
300	2	3751.250
420	2	3751.260
540	2	3751.270

Instrument cases/system enclosures

Rittal RiCase accessories



1



2



3

Support stand/carrying handle

- Support stand/carrying handle adjustable on a 30° pitch pattern.
- Suitable for retrofitting with 2 – 7 U.
- For 269.2 mm (1½ 19") and 482.6 mm (19") wide enclosures
- Load capacity 30 kg

Material:

Hinged part: Die-cast, spray-finished
Centre part: Extruded aluminium section, spray-finished with plastic cover

Colour:

RAL 7035

Decorative colours:

- 1 RAL 7030 (stone grey)
- 2 RAL 5018 (turquoise)
- 3 RAL 5012 (pale blue)

Supply includes:

Assembly parts.

For enclosure width mm	Decorative colour RAL	B mm	Model No. RC
269.2 (1½ 19")	5018 ¹⁾	392	3751.200
269.2 (1½ 19")	5012 ¹⁾	392	3751.202
269.2 (1½ 19")	7030	392	3751.204
482.6 (19")	5018 ¹⁾	605	3751.210
482.6 (19")	5012 ¹⁾	605	3751.212
482.6 (19")	7030	605	3751.214

B = Overall width of handle

¹⁾ Extended delivery times.

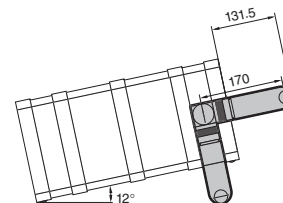

Keyboard lid

Suitable for the installation of 482.6 mm (19") key-boards.

- Horizontally hinged with security lock
- Removable cover plate

Material:

Frame section: Extruded aluminium section/die-cast, spray-finished
Base and cover plate: Aluminium, spray-finished.

Colour:

RAL 7035

Supply includes:

Assembly parts.

For enclosure width mm	H (U)	Packs of	Model No. RC
482.6 (19")	4	1	3751.800
482.6 (19")	6	1	3751.810

Note:

Use only in conjunction with support stand/carrying handle.

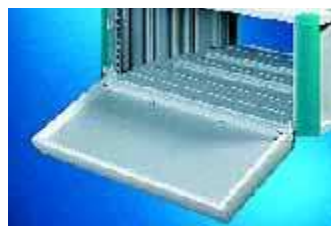
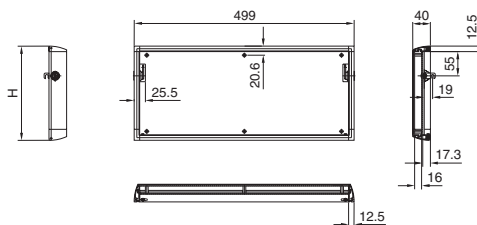

Glazed front door

vertically hinged

For mechanical protection of built-in control components.

- Optionally hinged on the right or left
- With security lock

Material:

Frame section: Extruded aluminium section, spray-finished
Corner pieces: Die-cast aluminium, spray-finished
Glass pane: Smoked acrylic

Colour:

RAL 7035

Supply includes:

Assembly parts.

For enclosure width mm	B mm	H (U)	Model No. RC
269.2 (1½ 19")	289	3	3751.300
269.2 (1½ 19")	289	4	3751.310
482.6 (19")	503	3	3751.320
482.6 (19")	503	4	3751.330
482.6 (19")	503	6	3751.340
482.6 (19")	503	7	3751.350

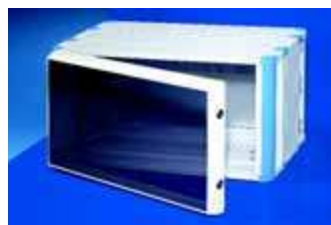
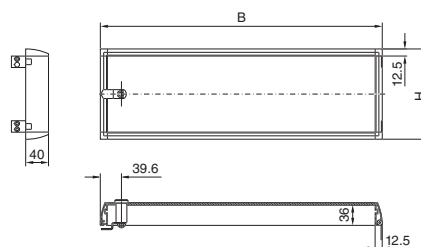



Aluminium front door

vertically hinged

For mechanical protection of built-in control components.

- Optionally hinged on the right or left
- With security lock

Material:

Frame section: Extruded aluminium section, spray-finished

Corner pieces: Die-cast aluminium, spray-finished

Aluminium plate

Colour:

RAL 7035

Supply includes:

Assembly parts.

For enclosure width mm	B mm	H (U)	Model No. RC
482.6 (19")	503	3	3751.360
482.6 (19")	503	4	3751.370
482.6 (19")	503	6	3751.380

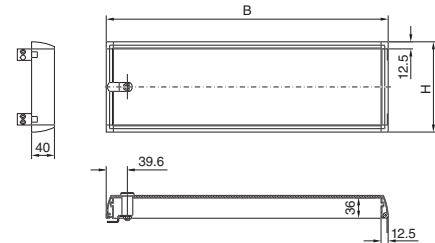

Front door

For tower enclosure

For mechanical protection of built-in control components.

- Optionally hinged on the right or left
- With security lock

Material:

Frame section: Extruded aluminium section, spray-finished

Corner pieces: Die-cast aluminium, spray-finished

Glazed pane: Smoked acrylic

Colour:

RAL 7035

Supply includes:

Assembly parts.

For enclosure width mm	B mm	H (U)	Model No. RC
482.6 (19")	503	3	3751.390
482.6 (19")	503	4	3751.430

B = Overall width of front door

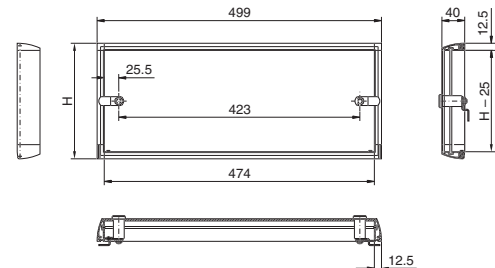

Tower feet

For vertical siting of enclosures. May be retrofitted.

Material:

Plastic to UL 94-V0, self-extinguishing

Decorative colours:

- 1 RAL 7030 (stone grey)
- 2 RAL 5018 (turquoise)
- 3 RAL 5012 (pale blue)

Supply includes:

4 tower feet, assembly parts.

Decorative colour RAL	Packs of	Model No. RC
5018	1 set	3751.850
5012	1 set	3751.852
7030	1 set	3751.854

1



2



3

Instrument cases/system enclosures

Rittal RiCase accessories



Back panel

Screw-fastened
To close off the rear.

Material:
2/3 mm aluminium, natural anodised

Supply includes:
482.6 mm (19") mounting bracket, assembly parts.

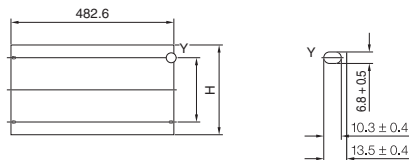

For enclosure width mm	H (U)	Packs of	Model No. RC
482.6 (19")	3	1	3751.600
482.6 (19")	4	1	3751.610
482.6 (19")	6	1	3751.620
482.6 (19")	7	1	3751.630
482.6 (19")	9	1	3751.530
482.6 (19")	12	1	3751.540



Rear door

vertically hinged
To close off the rear.

- Hinged, with security lock
- Optionally hinged on the left or right

Material:
Aluminium, spray-finished

Colour:
RAL 7035

Supply includes:
Assembly parts.

For Enclosure width mm	H (U)	Packs of	Model No. RC
482.6 (19")	3	1	3751.100
482.6 (19")	4	1	3751.110
482.6 (19")	6	1	3751.120
482.6 (19")	7	1	3751.130

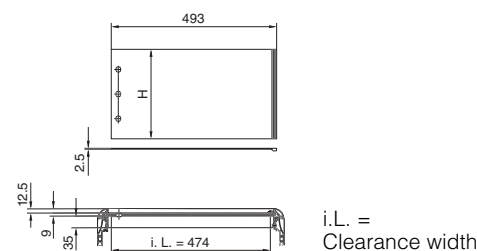

Instrument cases/system enclosures

3 B
6



Rear door

for fan installation
To close off the rear.

- With security lock
- Optionally hinged on the left or right
- For the installation of 120 mm fans

Material:
Aluminium, spray-finished

Colour:
RAL 7035

Supply includes:
Assembly parts.

For Enclosure width mm	H (U)	H1 mm	Model No. RC
482.6 (19")	3	66.65	3751.150
482.6 (19")	4	88.90	3751.160
482.6 (19")	6	83.50	3751.170
482.6 (19")	7	83.50	3751.180

+ Accessories:

Fan expansion kit, see page 649.

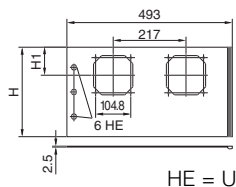

Assembly screws M6, see page 1019.
Captive nuts M6, see page 1020.



Fan expansion kit, see page 649.

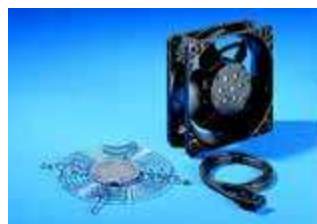

Blanking plates, see page 1013.
Hinged blanking plates, see page 1013.



Ventilation front panels, see page 1013.