

EM. STOP MUSHROOM PUSHBUTTON, 22MM, ROUND, METAL, SHINY, RED, 40MM, LATCHING, ROTATE TO UNLATCH, WITH YELLOW BACKING PLATE, INSCRIPTION: EMERGENCY STOP, WITH HOLDER, 1NC, SCREW TERMINAL



Figure similar

product brand name	SIRIUS ACT
Product designation	Commanding and signaling devices
Design of the product	EMERGENCY STOP mushroom pushbutton
Manufacturer article number	
<ul style="list-style-type: none"> • of supplied contact module • 1 of supplied contact module • of the supplied holder • of the supplied actuator • of supplied accessory 	<ul style="list-style-type: none"> 3SU1400-1AA10-1CA0 3SU1400-1AA10-1CA0 3SU1550-0AA10-0AA0 3SU1050-1HB20-0AA0 3SU1900-0BC31-0DA0

Enclosure:	
Number of command points	1

Actuator:	
Design of the operating mechanism	EMERGENCY STOP mushroom pushbutton; tamper-proof
Manner of function of the actuating element	Latching
Product expansion optional Light source	No
Color	
<ul style="list-style-type: none"> • of the actuating element 	Red
Material of the actuating element	plastic

Shape of the actuating element	round
Outer diameter of the actuating element	40 mm
Number of contact modules	1
Type of unlocking device	rotate-to-unlatch mechanism

Front ring:

Product component front ring	No
------------------------------	----

Holder:

Material of the holder	Metal
------------------------	-------

Display:

Number of LED modules	0
-----------------------	---

General technical data:

Product function	
• positive opening	Yes
• EMERGENCY OFF function	Yes
• EMERGENCY STOP function	Yes
Product component	
• Light source	No
Insulation voltage	
• rated value	500 V
Degree of pollution	3
Surge voltage resistance rated value	6 kV
Protection class IP	IP66, IP67, IP69(IP69K)
• of the terminal	IP20
Degree of protection NEMA rating	NEMA 1, 2, 3, 3R, 4, 4X, 12
Shock resistance	
• acc. to IEC 60068-2-27	Sinusoidal half-wave 50 g / 11 ms
Vibration resistance	
• acc. to IEC 60068-2-6	10 ... 500 Hz: 5g
Operating frequency maximum	600 1/h
Mechanical service life (switching cycles)	
• typical	300 000
Electrical endurance (switching cycles)	
• typical	300 000
Thermal current	10 A
Equipment marking	
• acc. to DIN EN 61346-2	S
• acc. to DIN EN 81346-2	S
Continuous current of the C characteristic MCB	10 A; for a short-circuit current smaller than 400 A
Continuous current of the quick DIAZED fuse link	10 A

Main circuit:

Operating voltage	
-------------------	--

- rated value

5 ... 500 V

Power Electronics:

Contact reliability	One maloperation per 100 million (17 V, 5 mA), one maloperation per 10 million (5 V, 1 mA)
----------------------------	--

Auxiliary circuit:

Design of the contact of auxiliary contacts	Silver alloy
--	--------------

Number of NC contacts

- for auxiliary contacts

1

Number of NO contacts

- for auxiliary contacts

0

Number of CO contacts

- for auxiliary contacts

0

Connections/ Terminals:

Type of electrical connection

- of modules and accessories

Screw-type terminal

Type of connectable conductor cross-sections

- solid with core end processing
- solid without core end processing
- finely stranded with core end processing
- finely stranded without core end processing
- at AWG conductors

2x (0.5 ... 0.75 mm²)

2x (1.0 ... 1.5 mm²)

2x (0.5 ... 1.5 mm²)

2x (1,0 ... 1,5 mm²)

2x (18 ... 14)

Connectable conductor cross-section

- finely stranded with core end processing

0.5 ... 1.5 mm²

Tightening torque of the screws in the bracket

1 ... 1.2 N·m

Tightening torque

- for auxiliary contacts with screw-type terminals

0.8 ... 0.9 N·m

Safety related data:

B10 value

- with high demand rate acc. to SN 31920

100 000

Ambient conditions:

Ambient temperature

- during operation
- during storage

-25 ... +70 °C

-40 ... +80 °C

Installation/ mounting/ dimensions:

Mounting type

- of modules and accessories

front mounting

Front plate mounting

Height

40 mm

Width

30 mm

Shape of the installation opening

round

Mounting diameter

22.3 mm

Mounting height	46.4 mm
Installation width	75 mm
Installation depth	48.6 mm

Accessories:

Number of backing plates	1
Marking of backing plate	EMERGENCY STOP
Color of backing plate	Yellow

Certificates/approvals

General Product Approval	For use in hazardous locations	Declaration of Conformity
--------------------------	--------------------------------	---------------------------



[Herstellereklärung](#)



Shipping Approval	other
-------------------	-------



[Bestätigungen](#)

Further information

Information- and Downloadcenter (Catalogs, Brochures,...)

<http://www.siemens.com/industrial-controls/catalogs>

Industry Mall (Online ordering system)

<https://mall.industry.siemens.com/mall/en/en/Catalog/product?mlfb=3SU11501HB201CG0>

Cax online generator

<http://support.automation.siemens.com/WW/CAXorder/default.aspx?lang=en&mlfb=3SU11501HB201CG0>

Service&Support (Manuals, Certificates, Characteristics, FAQs,...)

<https://support.industry.siemens.com/cs/ww/en/ps/3SU11501HB201CG0>

Image database (product images, 2D dimension drawings, 3D models, device circuit diagrams, EPLAN macros, ...)

http://www.automation.siemens.com/bilddb/cax_de.aspx?mlfb=3SU11501HB201CG0&lang=en

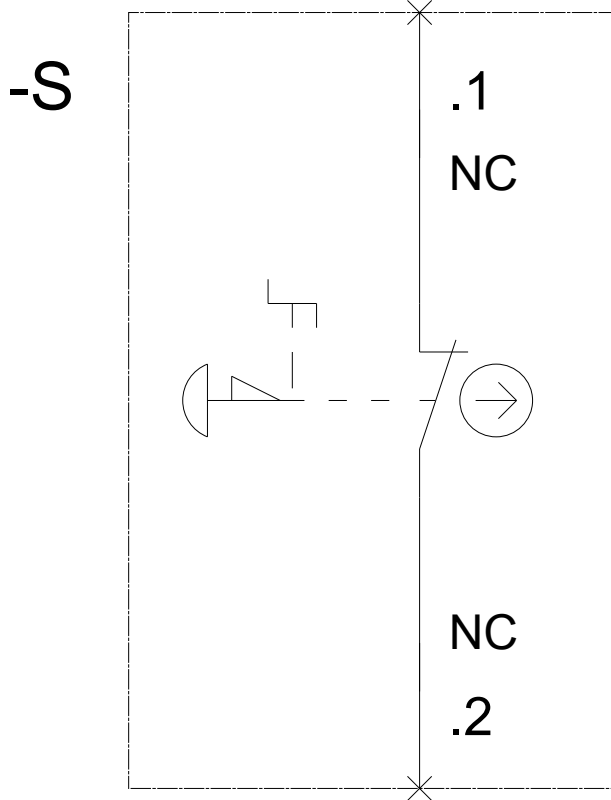
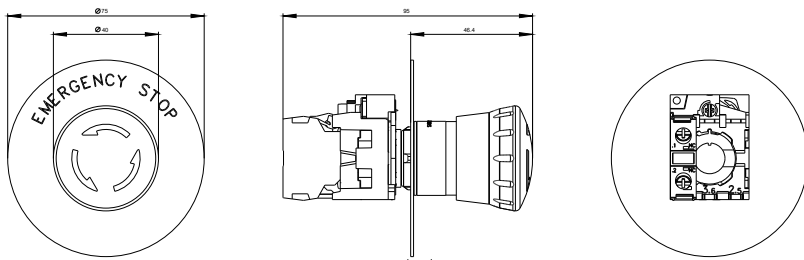

last modified:

24.02.2016